



DEVELOPMENT PERMIT APPLICATION FORM

Phone: 780-349-3346

www.westlockcounty.com

10336-106 Street, Westlock, Alberta T7P 2G1

Internal Use Only

File Number: _____ Roll Number: _____ Application Date: _____

Applicant Information

Applicant/Agent: _____ Phone: _____

Address: _____ Cell Phone: _____

City/Prov. _____ Postal Code: _____ Fax: _____

Email address: _____ Signature: _____

Applicant/Agent Authorization: I am the applicant/agent authorized to act on behalf of the registered owner and that the information given on this form is full and complete and is, to the best of my knowledge, a true statement of the facts relating to this application.

Registered Landowner Information

Owner same as applicant

Registered Owner: _____ Phone: _____

Address: _____ Fax: _____

City/Prov. _____ Postal Code: _____ Signature: _____

Section A - Property Information

Legal: Lot ____ Block ____ Plan _____ and/or Part of ____ ¼ Sec ____ Twp ____ Rge ____ W4/5M

Subdivision Name (if applicable) _____

Rural Address/Street Address _____ Parcel Size _____

Number of existing dwellings on property (please describe)

Has any previous application been filed in connection with this property? Yes No

If yes, please describe the details of the application and file number:

Is the subject property near a steep slope (exceeding 15%)? Yes No

Is the subject property near or bounded by a body of water? Yes No

Is the subject property within 800m of a provincial highway? Yes No

Is the subject property near a Confined Feeding Operation? Yes No Distance: _____

Is the subject property within 1.5km of a sour gas facility? Yes No Distance: _____

Is the subject property within 1.5km of a sewage treatment plant/lagoon? Yes No Distance: _____

Is the property the subject of a licence, permit, approval, or other authorization granted by the Natural Resources Conservation Board, Energy Resources Conservation Board, Alberta Energy Regulator, Alberta Energy and Utilities Board or Alberta Utilities Commission? Yes No

If yes, please describe: _____

Is the property the subject of the application is the subject of a licence, permit, approval, or other authorization granted by the Minister of Environment or granted under any Act the Minister is responsible for under s.16 of the Government Organization Act*? Yes No

If yes, please describe: _____

Is the subject property immediately adjacent to the County boundary? Yes No

If yes, the adjoining municipality is: _____

**The Minister is responsible for the following Acts: AB Land Stewardship Act, Environmental Protection Act, Public Lands Act, Surveys Act, Water Act. Please see attached list of resources for identifying this information.*

Section B – Proposed Development Information

Estimated Cost of Project \$ _____

Estimated Commencement Date: _____ Estimated Completion Date: _____

Dwelling:

Floor Area _____ sq. ft. % of Lot Occupied _____ Height of Dwelling _____ ft / m

Accessory Building:

Floor Area _____ sq. ft. % of Lot Occupied _____ Height of Acc. Bldg _____ ft / m

Parking: # of Off-Street Parking Stalls (if applicable) _____

Land Use District (Zoning) of Property: _____

Description of Work:

Section C – Preferred Method of Communication

When a decision has been made on your file, do you wish for us to:

- mail the decision email the decision

Section 608(1) of the *Municipal Government Act*, R.S.A. 2000, c. M-26, as amended states:

608(1) Where this *Act* or a regulation or bylaw made under this Section requires a document to be sent to a person, the document may be sent by electronic means if:

- a) the recipient has consented to receive documents from the sender by those electronic means and has provided an e-mail address, website or other electronic address to the sender for that purpose.

I/we grant consent for the Development Authority to communicate information and/or the decision electronically regarding my/our application. YES NO

Personal Information required on this application form is collected under the authority of sections 33(a) and (c) of the Alberta Freedom of Information and Protection or Privacy (FOIP) Act (the "FOIP ACT"). Your personal information will be used to process your application. Please be advised that your name, address, and details related to your permit will be disclosed to the Alberta Safety Codes Authority for the purpose of compliance with the Safety Codes Act. Disclosure of your personal information is completed under the authority of section 40(1)(c) of the FOIP Act.

<p>OFFICE USE ONLY</p> <p>Type of Payment: <input type="checkbox"/> DEBIT <input type="checkbox"/> CASH <input type="checkbox"/> CHEQUE <input type="checkbox"/> MC <input type="checkbox"/> Visa <input type="checkbox"/> EFT</p> <p>Fee \$ _____</p> <p>Receipt # _____</p> <p>Receipt Date _____</p> <p>Deemed Complete _____</p> <p><small>*and deemed complete by Development Authority.</small></p>	<p>Authorization: <input type="checkbox"/> Permitted Use <input type="checkbox"/> Discretionary Use</p> <p>Issuing Officer's Name _____</p> <p>Date of Approval _____</p> <p>Date Issued _____</p> <p>Comments and/or Variances _____</p> <p>_____</p>
--	---

DEVELOPMENT PERMIT SITE PLAN

Internal Use Only

File Number: _____

Roll Number: _____

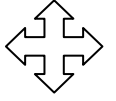

DATE:

SIGNATURE OF APPLICANT:

DATE:

DEVELOPMENT AUTHORITY:

SAMPLE SITE PLAN

*Sample site plan not drawn to scale.

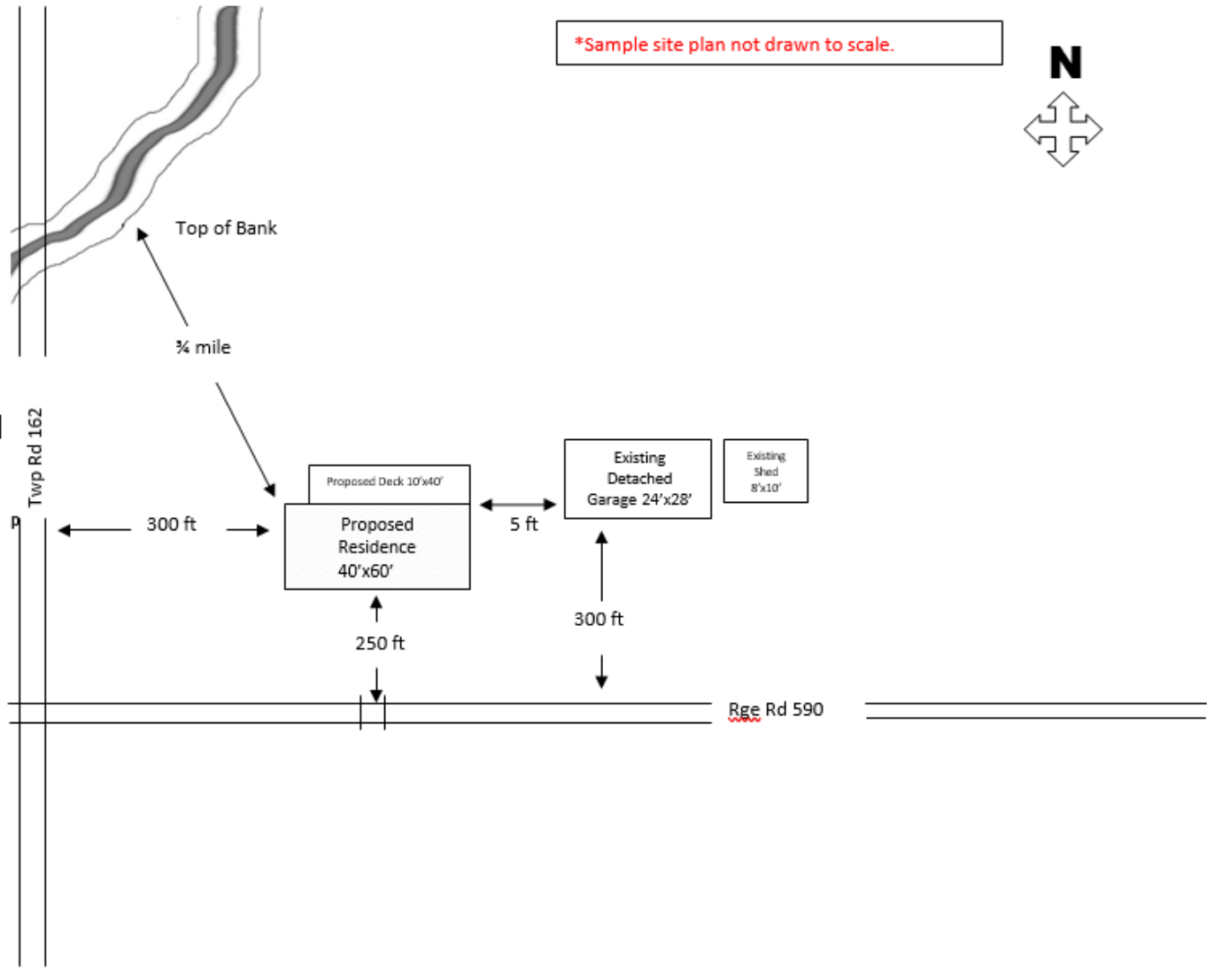

INCLUDE THE FOLLOWING INFORMATION IN YOUR SITE PLAN:

<ul style="list-style-type: none"> ✓ Location of existing buildings. ✓ Location of proposed buildings. ✓ Location of existing access (es). ✓ Location any proposed access (es). ✓ Location of any abandoned wells. ✓ Location of shelterbelts and dugouts. ✓ Location of water well(s). 	<ul style="list-style-type: none"> ✓ Front, Side and Rear Yard setbacks from <u>property lines</u> in meters/feet. ✓ Location of any water bodies on subject property. ✓ Location of driveway. ✓ All developed/undeveloped road allowances. 	<ul style="list-style-type: none"> ✓ Location of Private Sewage Disposal System (existing and/or proposed). ✓ Indicate the North direction. ✓ Location of all right-of-way and easements within or abutting the subject property. ✓ Location of power generation facilities (if applicable).
--	---	--